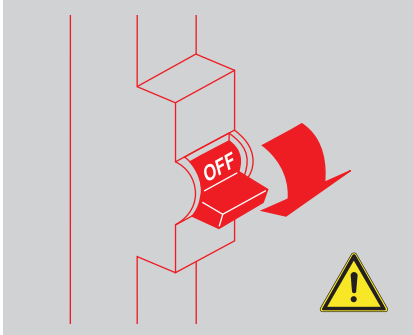
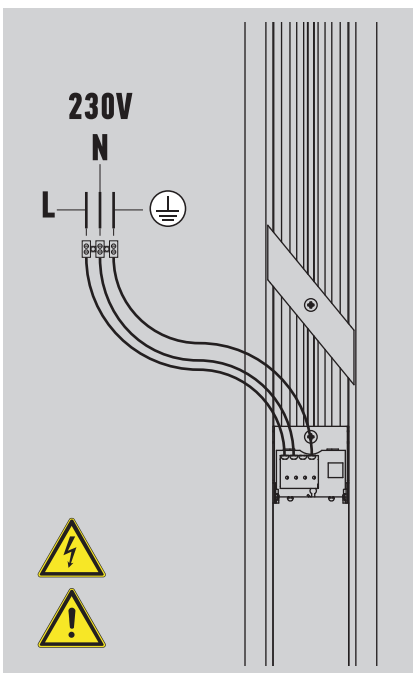
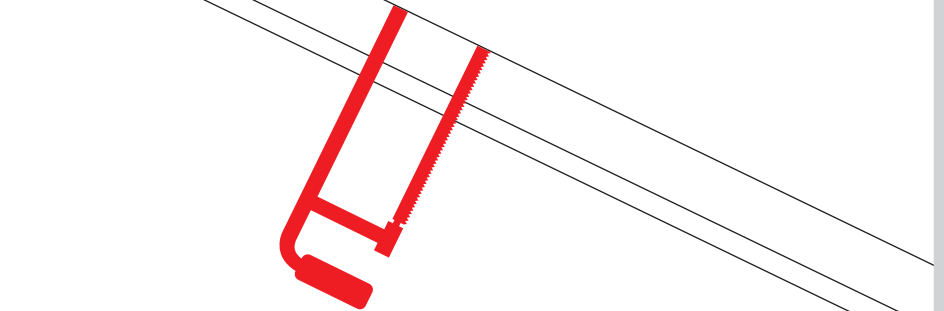

**ATLAS 35 RECESSED**

Κλείστε την παροχή ρεύματος.  
Power off.

1/2

**38mm**

Κόψτε στις διαστάσεις του σώματος.  
Cut according to light dimensions.

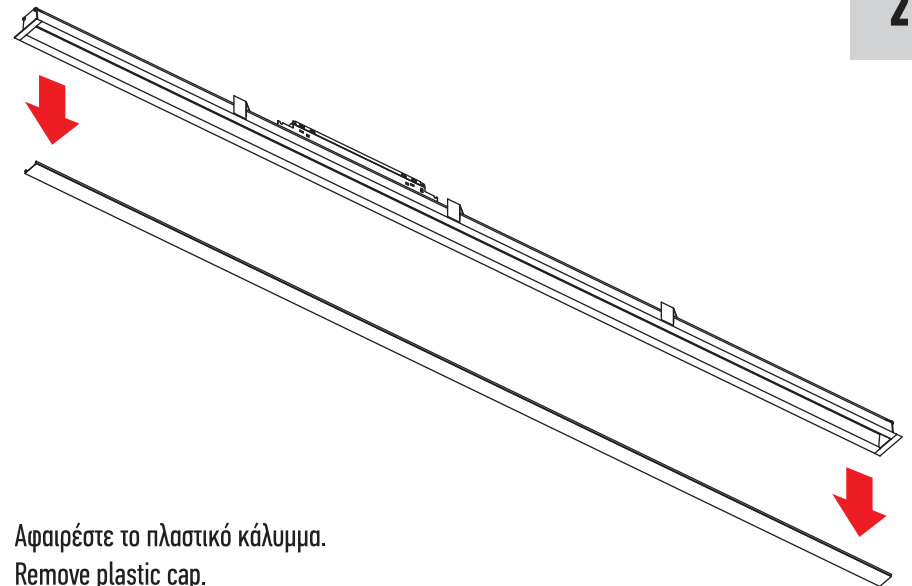
**1**

Αφαιρέστε το πλαστικό κάλυμμα.  
Remove plastic cap.

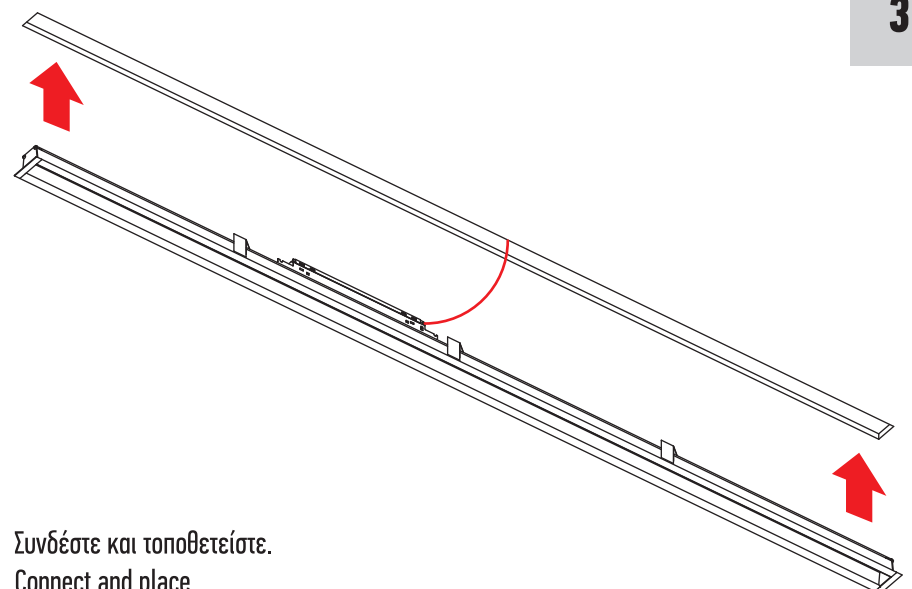
**2**

Συνδέστε και τοποθετείστε.  
Connect and place.

**3**

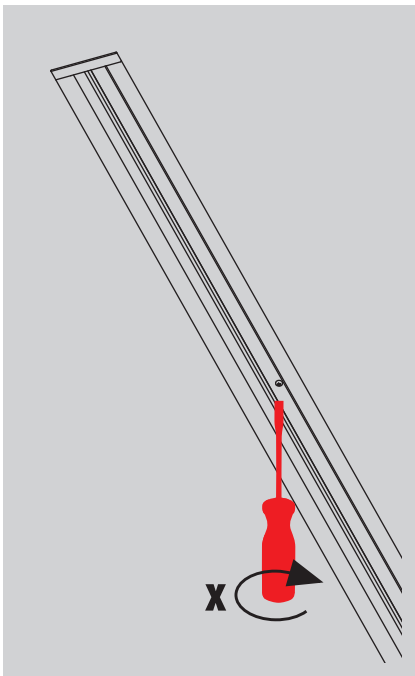

Περιστρέψτε τις βίδες εσωτερικά, για να "αγκιστρωθεί" το σώμα.  
Fasten internal screws until light hooks.

4

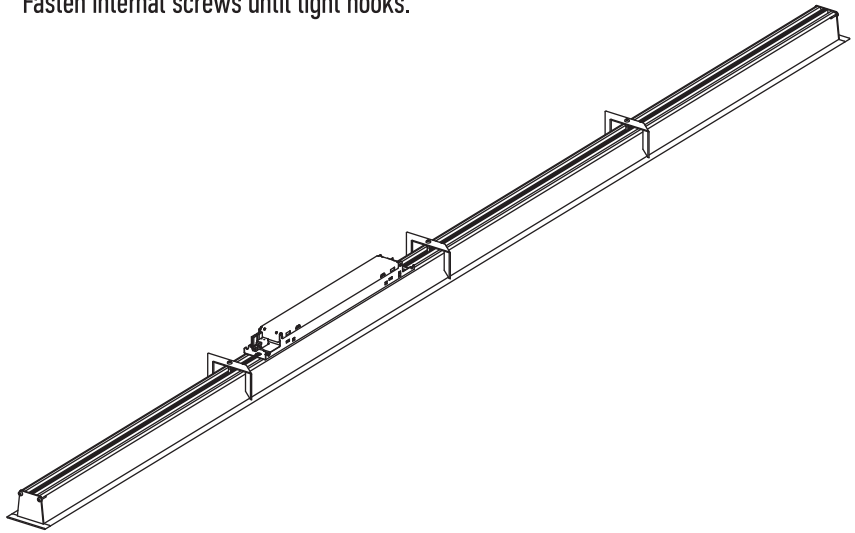

2/2

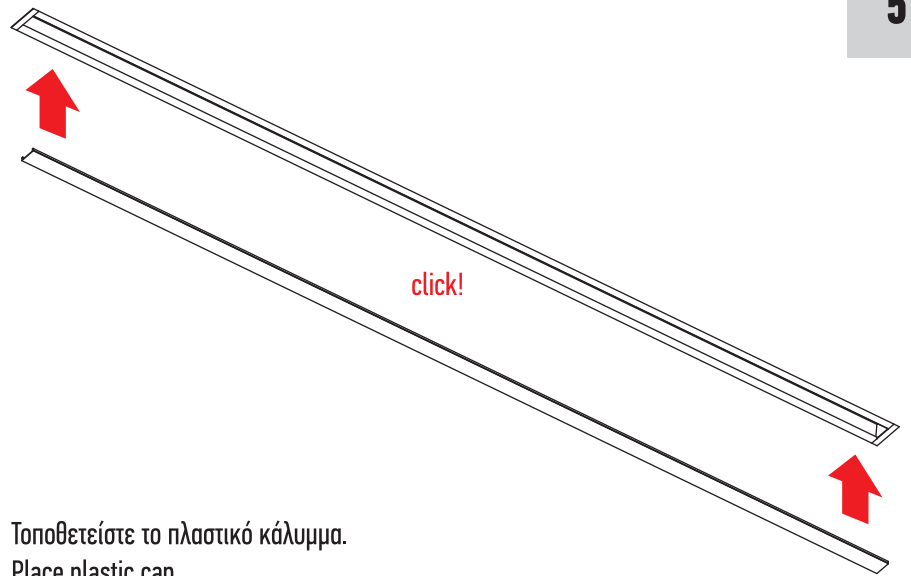

5

Τοποθετείστε το πλαστικό κάλυμμα.  
Place plastic cap.

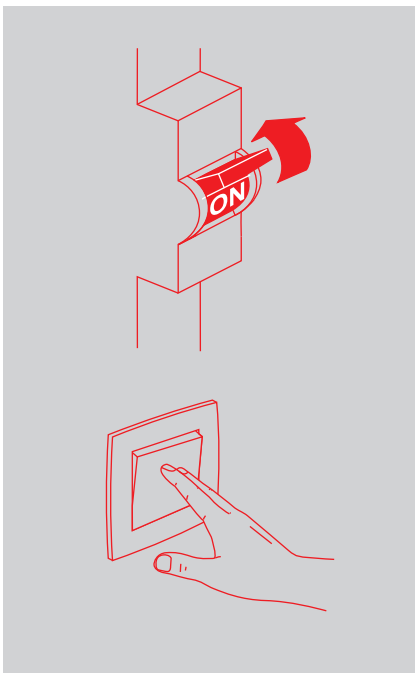

6

